

Upper Arm Bushing (60.35.32)

Special Service Tools



Ball joint separator
205-754 (LRT-54-027)



Receiver cup upper arm bushes
204-532/1



Remover upper arm bushes
204-532/2



Installer upper arm front bush
204-532/3



Installer upper arm rear bush
204-532/4

Removal

NOTE:

The bushings must be replaced in pairs, LH and RH sides.

1 .



WARNING: Do not work on or under a vehicle supported only by a jack. Always support the vehicle on safety stands.

Raise and support the vehicle.

2 . Remove the front wheels and tires.

3 . Remove the LH upper arm.

For additional information, refer to [Upper Arm \(60.35.01\)](#)

4 . Release the heat shield for access to the upper arm bolts.



Remove the retaining nut and two bolts.

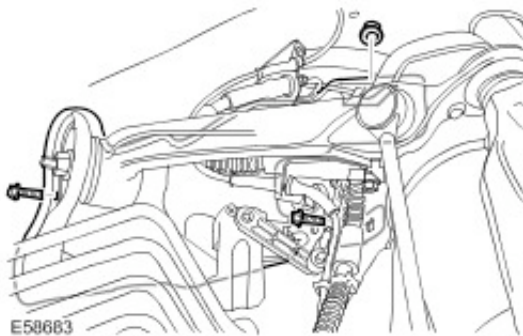

5 . Loosen the upper arm bolts.

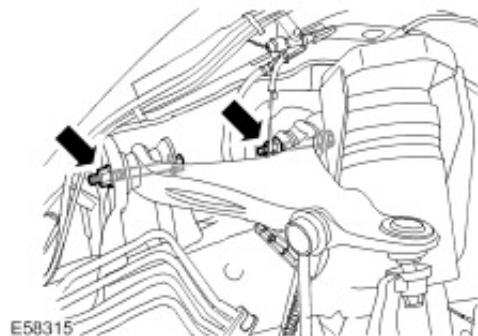

6 . Disconnect the height sensor link.

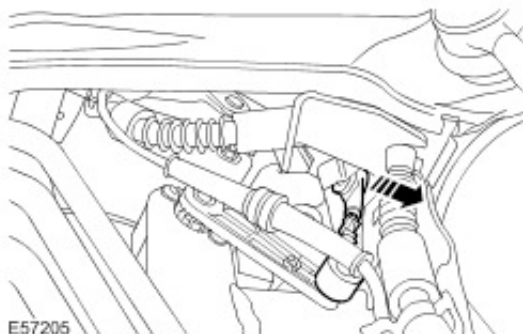

7



CAUTION: Use a Torx socket to prevent the ball joint rotating whilst removing the nut.



CAUTION: Note the position of the hardened steel washer. The hardened steel washer must be installed between the stabilizer bar link and the upper arm. Failure to follow this instruction may result in damage to the vehicle.

Remove the stabilizer bar link nut.

 Discard the nut.

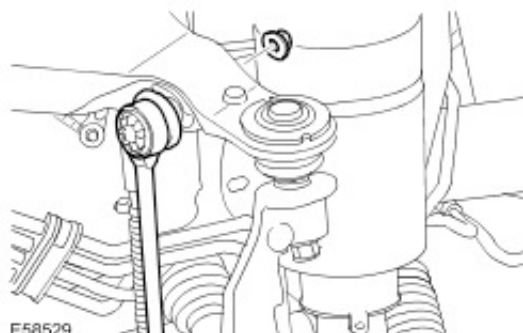

8



CAUTION: To prevent the wheel knuckle falling outwards and disconnection of the halfshaft inner joint, support the wheel knuckle.

Loosen the upper arm retaining nut.

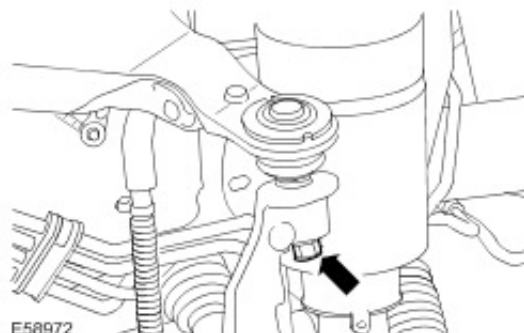

9 . Using the special tool, release the upper arm ball joint.

 Remove and discard the retaining nut.



- 10 . Release the brake hose from the upper arm.
- 11 . Release the wheel speed sensor lead from the upper arm.
- 12 . Remove the RH upper arm.

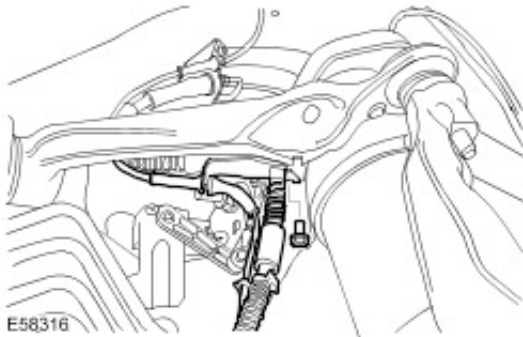

- 13 . Note the position of the bushing in relation to the upper arm.

14 .



CAUTION: The bush flanges need to be removed to allow bush removal.

Using a suitable tool, bend over the bush flanges.

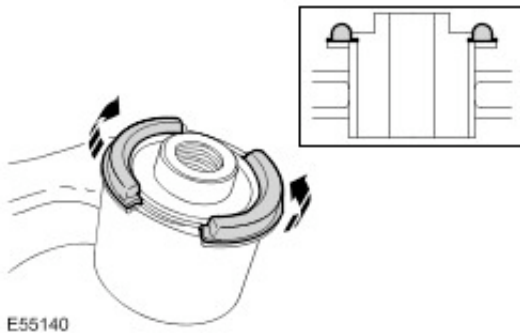

- 15 . Using a hacksaw, remove the flange from the bushing, making sure the upper arm is not damaged.
- 16 . Using the special tools, remove and discard the upper arm bushings.

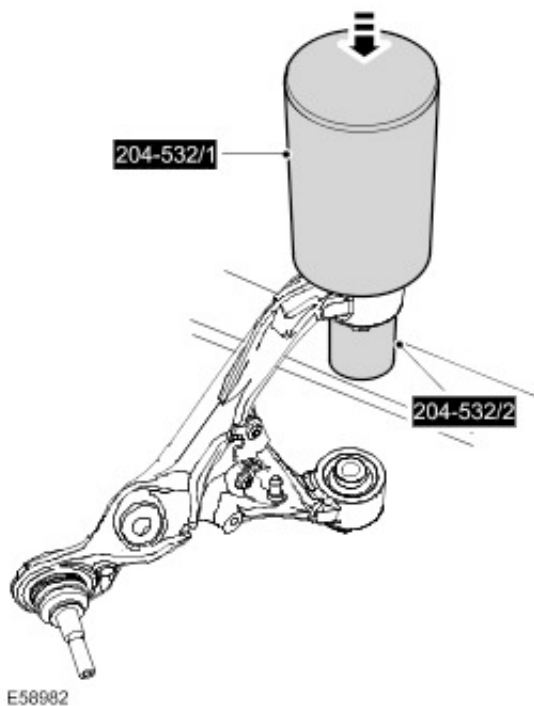

Installation

All vehicles

1.



CAUTION: Make sure the correct special tool is used to install the bushings to the correct depth.

Using the special tools, install the upper arm rear bushings.



Align the arrow on the bush with the mark, previously made on the upper arm.

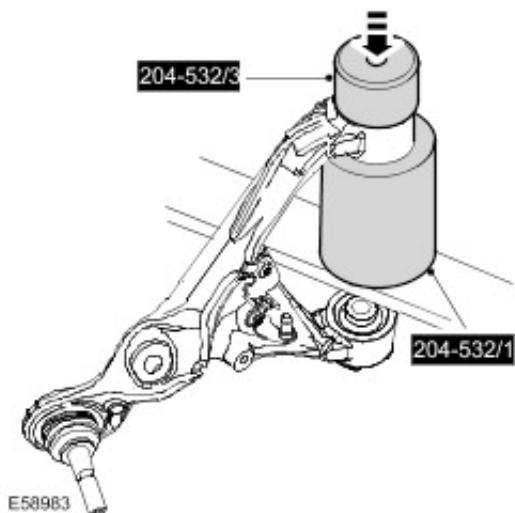

2. Using the special tools, install the upper arm front bushings.



Align the arrow on the bush with the mark, previously made on the upper arm.

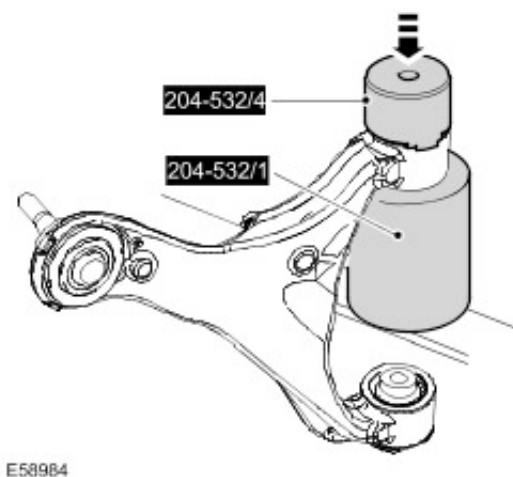

- 3 . Install the RH upper arm.
 - Fit the bolts but do not fully tighten at this stage.
- 4 . Secure the brake hose to the upper arm.
 - Tighten the bolt to 23 Nm (17 lb.ft).
- 5 . Secure the wheel speed sensor lead to the upper arm.
- 6 . Connect the upper arm and wheel knuckle.
 - Install a new nut and tighten to 70 Nm (52 lb.ft).

Vehicles without Active Stabilization

- 7 . **CAUTION: Make sure the hardened steel washer is installed between the stabilizer bar link and the upper arm. Failure to follow this instruction may result in damage to the vehicle.**

- CAUTION: Use a Torx socket to prevent the ball joint rotating whilst installing the nut.**

Secure the stabilizer bar link.

- Install a new nut and tighten to 175 Nm (129 lb.ft).

Vehicles with Active Stabilization

- 8 . **CAUTION: Make sure the hardened steel washer is installed between the stabilizer bar link and the upper arm. Failure to follow this instruction may result in damage to the vehicle.**

- CAUTION: Use a Torx socket to prevent the ball joint rotating whilst installing the nut.**

Secure the stabilizer bar link.

 Install a new nut and tighten to 175 Nm (129 lb.ft).

All vehicles

9 . Connect the height sensor link.

10 . Set the height distance, between the center of the halfshaft end, and the edge of the fender to 462 mm (18.19").

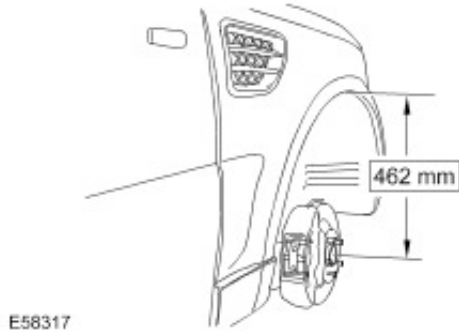

11 . Tighten the 2 upper arm nuts and bolts to 175 Nm (129 lb.ft).

12 . Secure the heat shield.

 Tighten to 10 Nm (7 lb.ft).

13 . Install the LH upper arm.

For additional information, refer to [Upper Arm \(60.35.01\)](#)

14 . Install the front wheels and tires.

 Tighten the wheel nuts to 140 Nm (103 lb.ft).